

**MOBILE APP FOR
COLLEGE STUDENTS WITH
MOOD DISORDERS**

USABILITY STUDY

HCI 596

Dana Lynn

Bethany Burdt

Vince Sonson

USABILITY STUDY FOR MOOD APP

- Thank you for participating in the usability study for a new mobile app designed for students with mood disorders such as depression and bipolar.
- Your feedback is very important to us and will assist us in designing a positive user experience for students who have needs such as this.
- Remember there are no right or wrong answers while taking the test.
- Please talk aloud while performing the tasks.

SCENARIO #2

Thomas has just been diagnosed with clinical depression while at school. He is taking medication for the first time. His physician suggests that he keep track of his medication dosage, as well as other lifestyle data that might be useful in treating his depression including mood, exercise, drinking, sleeping.

He is very nervous about any of his friends finding out that he has been diagnosed with depression and is on medication. He carries his mobile phone with him everywhere and is concerned with people seeing any personal information on his device.



SCENARIO #2

TASK 1

- Where would you go to set your privacy settings?

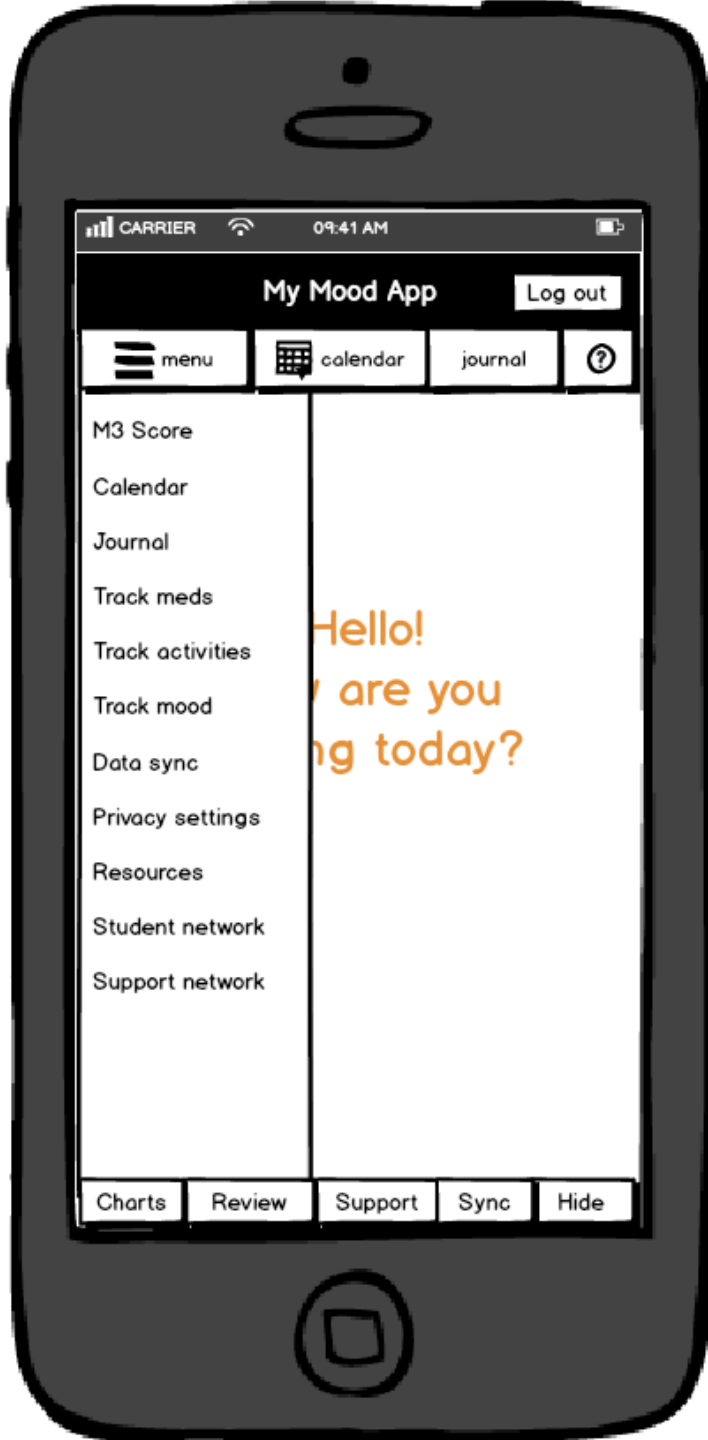

SCENARIO #2

TASK 1

- What privacy settings are important to you?

SCENARIO #2

TASK 1

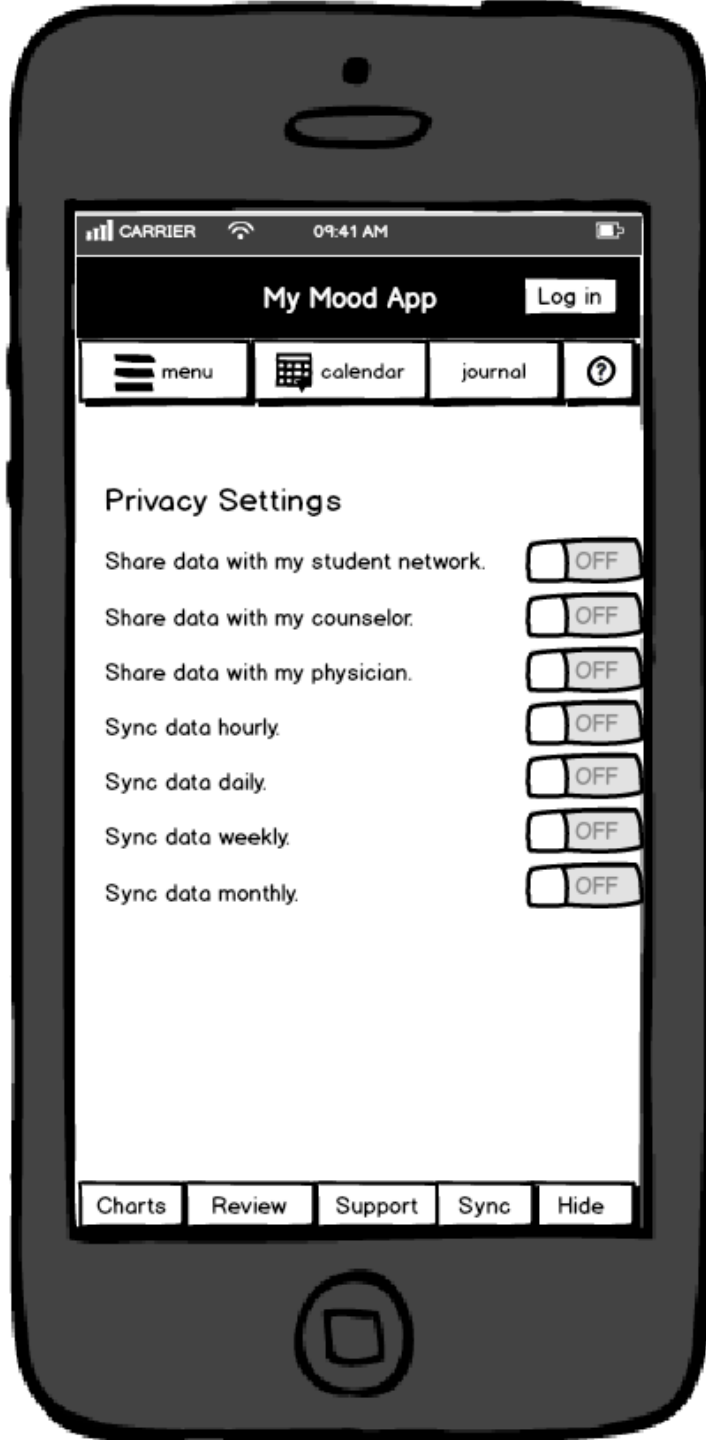

- Choose your privacy settings.

SCENARIO #2

TASK 2

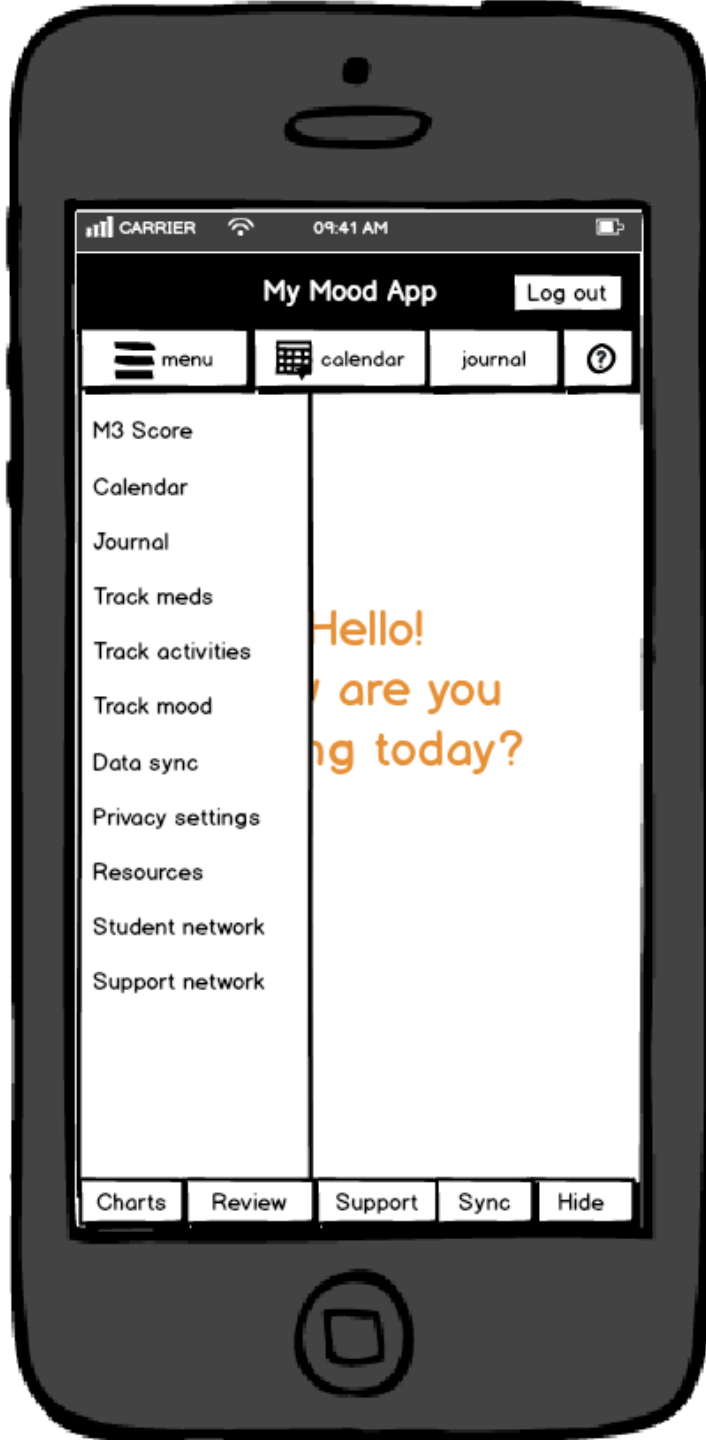

- Where would you click to record information about your medication?



SCENARIO #2

TASK 2

- Is this step necessary?

SCENARIO #2

TASK 2

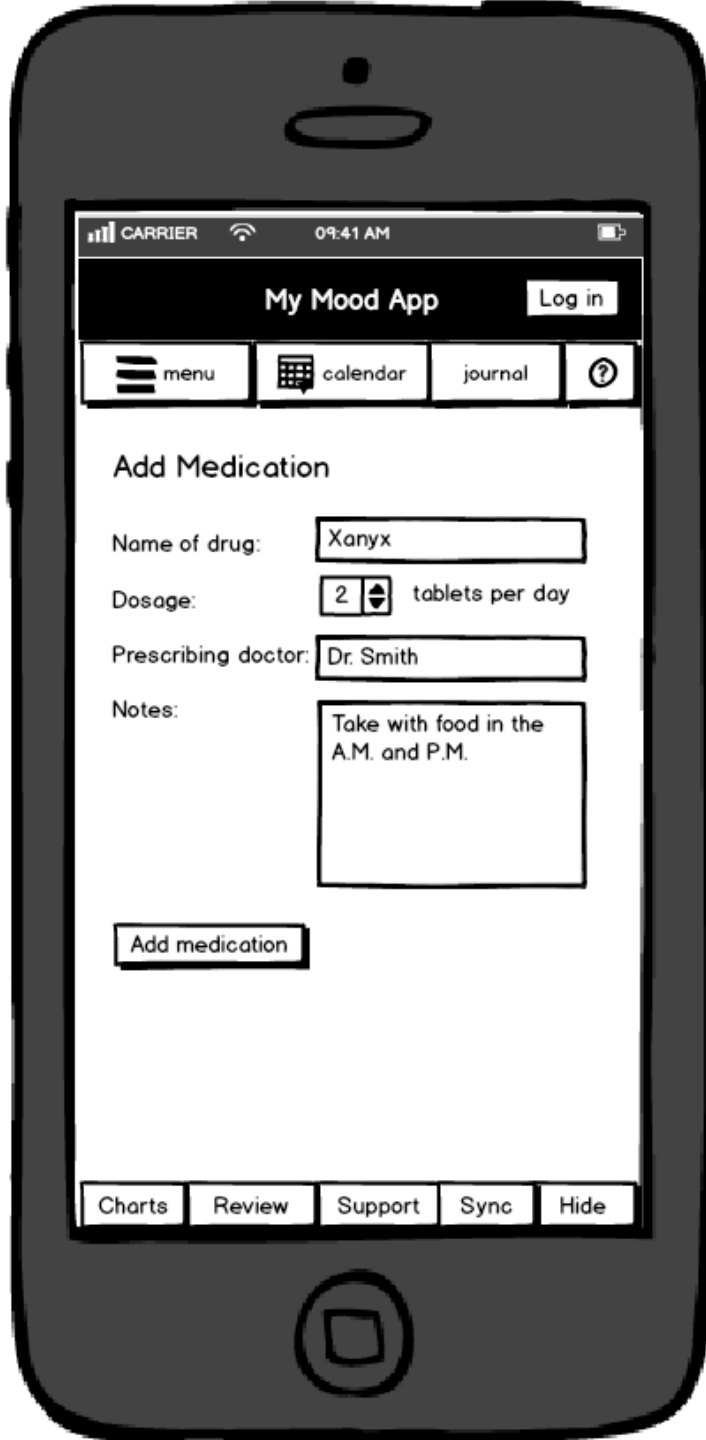

- What details should be recorded about a persons medication?

SCENARIO #2

TASK 2

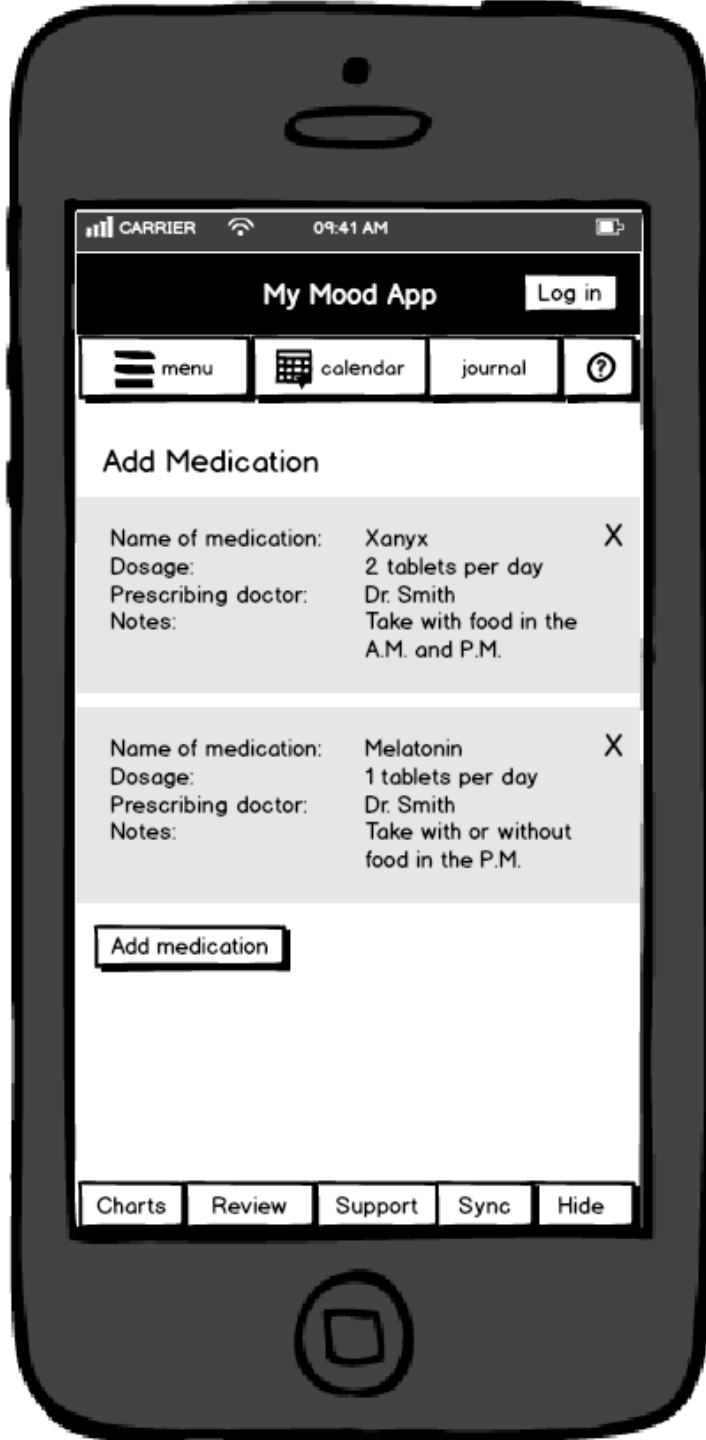

- Should this be the first view off of the main menu if you have already added medications?
- How would you remove a medication?
Answer: Swipe to the left or use X control?
- How would you edit a medication?
Answer: Double click to open medication or use an edit icon?

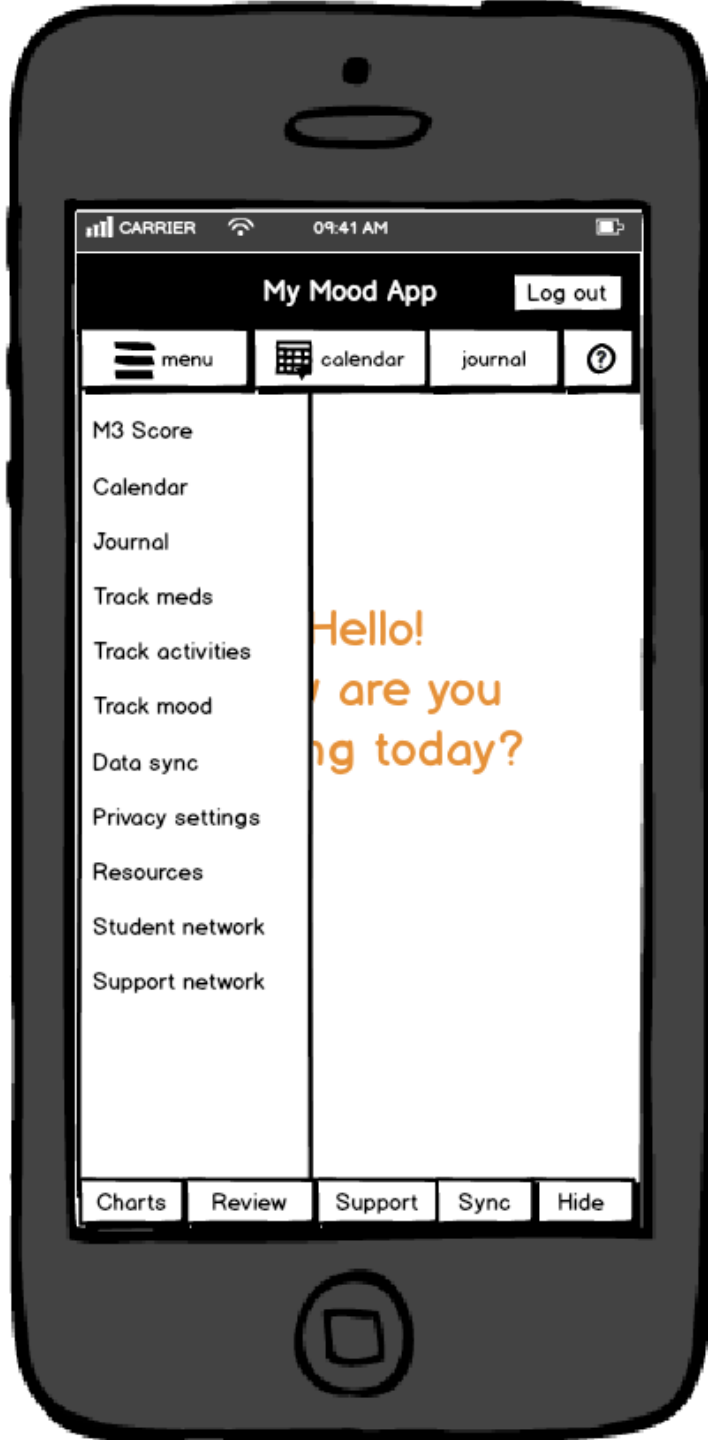

SCENARIO #2

TASK 3

- Why should a student track activities?

SCENARIO #2

TASK 3



- Why would you add tags to an activity?

SCENARIO #2

TASK 3

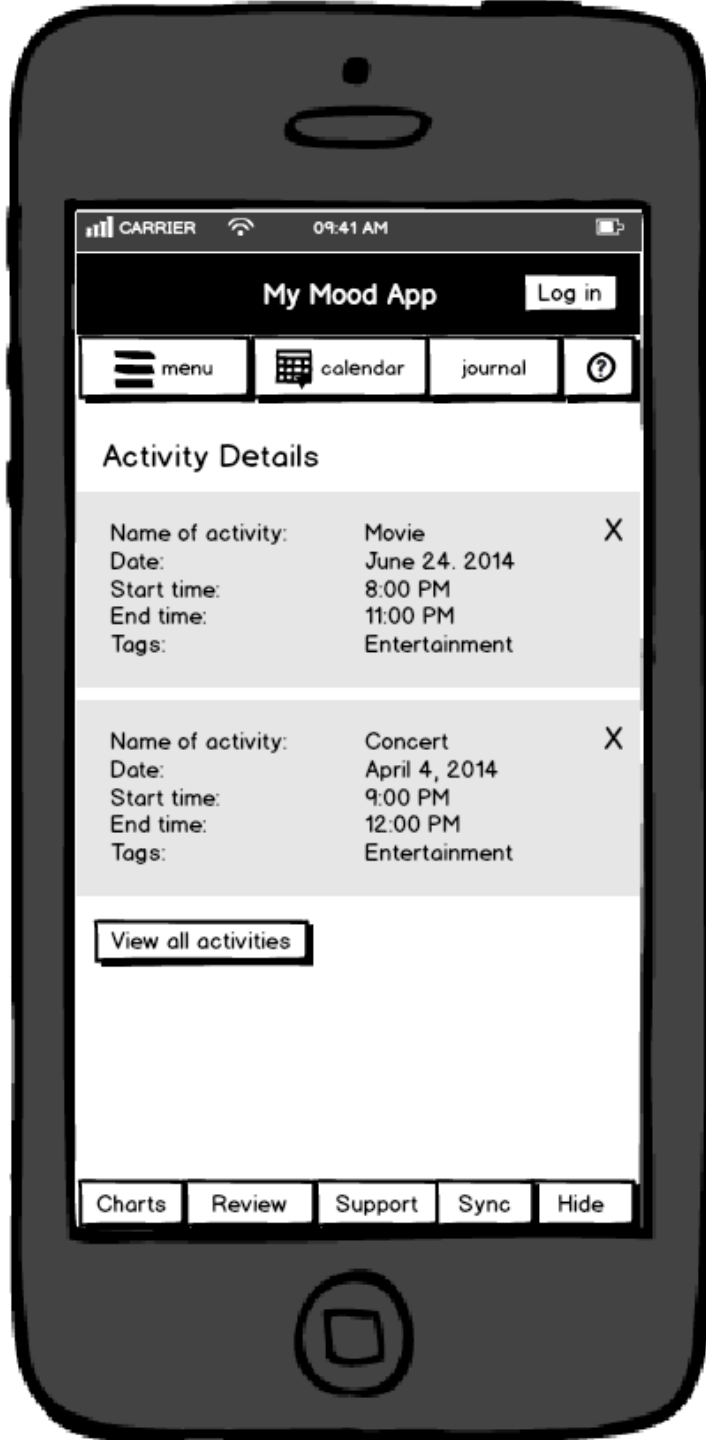

- Should the UX for edit and remove activities be the same as tracking medication?
- View all activities.

SCENARIO #2

TASK 3



- What do the different size boxes represent with regard to activities?